

AGPTEK

User Instructions

Solar Ground Light

About the color of the lights: light bluish tint. If the white light you see is towards light bluish tint, this is normal. Although it is not as bright as pure white, this color is more suitable for decorative lights. We hope you like it.

Product Contents

12 x Solar Ground Light
12 x Split Ground Stake
12 x Sharp End Ground Stake

Specifications

Material: PP, PC, Stainless steel
Size: 11.5*11.5*12.5cm
Battery: 1*AAA Ni-MH 600mAh

Diagram

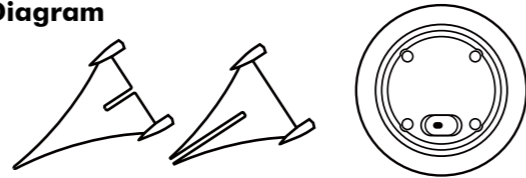

Assembly & Use

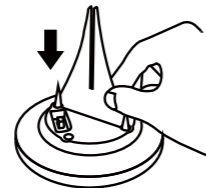

1. Align the 2 pins of split ground stake to the 2 holes on the back of solar ground light and push the split ground stake firmly onto the solar ground light.

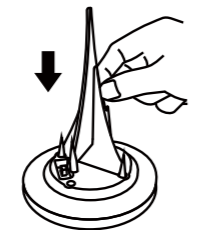

2. Align the 2 pins of sharp end ground stake to the 2 remaining holes on the back of solar ground light. And push the sharp end ground stake through the slot of the split ground stake onto the solar ground light.



3. Turn on the power switch to activate the light.



4. Insert the light into a soft ground where the solar panel can receive direct sunlight.

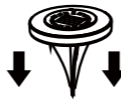

Note: If you do not use the product for a long time, please pull it out and turn off the power switch to deactivate it. Then disassemble and store it.

Contact Us

If any questions, please feel free to contact us:

✉ support@agptek.com