

AGPTEK

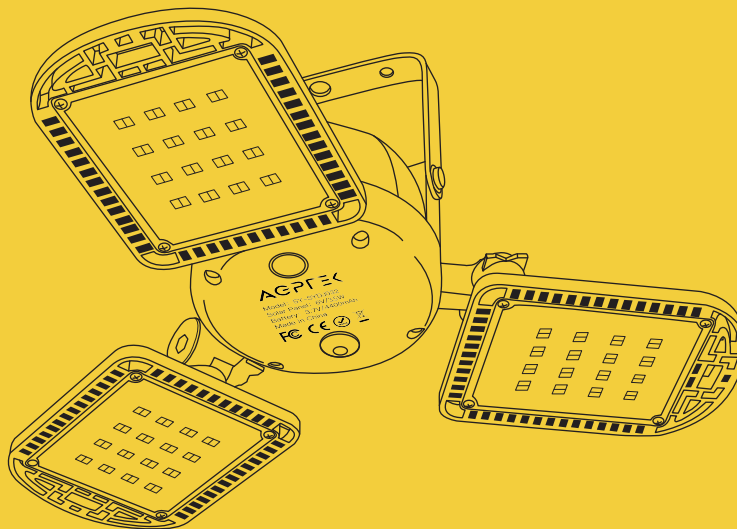

Solar Garage Light User Manual

Model: SY-SYDJ032



Website: <http://www.agptek.com/>



E-mail: support@agptek.com

Recommendations:

- Please charge the light for 4–5 hours before the first use.
- This product has a battery, please keep away from the fire source to avoid explosion danger.
- It is not allowed to disassemble solar panels and batteries without authorization.
- Solar panels should be placed in a place exposed to sunlight, and the angle should be adjusted to get enough sunshine.
- Please keep the surface of solar panel clean. It is recommended to clean it every 2 months to make charging faster and stronger.

Product Features:

1.This light is an energy-saving portable solar charging and lighting product. It is easy to install, free of wiring and zero electricity cost.

2.This product can be widely used in rural roads, trails,courtyards, garages, barns, gardens, orchards, fishing grounds and other places where it is not convenient to use electricity.

3.After fully charged, the light can be used separately, suitable be used as camping and emergency light.

Package Content:

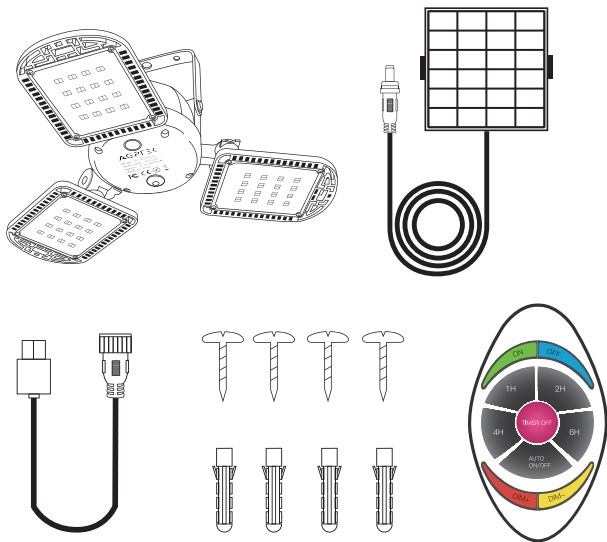

Warm Tip:

Please check the package when receiving the goods. If any missing or defective parts are found, please contact us for help.

Remote Controller Introduction:

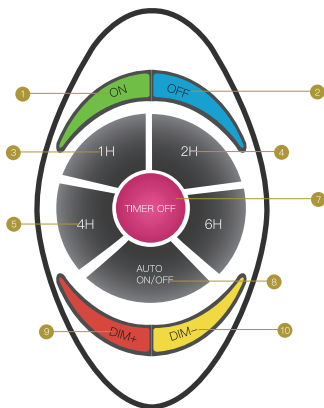

1. Power ON
2. Power OFF
3. 1 Hour Lighting
4. 2 Hours Lighting
5. 4 Hours Lighting
6. 6 Hours Lighting
7. TIMER OFF
8. Auto ON/OFF
9. Dimming+
10. Dimming-

Function Introduction:

Switch On & Off

ON: Power on button. Press it and the light is on.

OFF: Power off button. Press it and can turn off the light under both 2 modes.

Timing Function

1H/2H/4H/6H: Timing button. After pressing the corresponding number button, the light flashes once and keeps on for a specific period of time.

TIMER OFF: Turn off regularly, and the light flashes twice, indicating that it is canceled regularly.

(★ **Note:** ①The timing function will only work on the first time, not for the second time and after. For example, if the timing is pressed for 1H first, pressing 1H or 2H/3H/4H again will not work when the middle button is not pressed to cancel the timing closure, and the timing will be calculated as 1H for the first time. To reset the timing, press to cancel the timing before setting the timing. ②In the light control mode, the timer function starts counting down when it lights up. 24-hour cycle timing in no light control mode.)

Brightness Adjustment

DIM+/DIM-: Dimming button. You can adjust the brightness of the light according to your needs. There are 4 levels: 25%, 50%, 75%, 100%.

Working Mode Selection

AUTO ON/OFF: Switch button for light-sensitive automatic control mode and manual control mode. Press the AUTO button to turn on the light-sensitive control mode: during the day, the light will be off and the system will automatically charge. At night, the light will light up automatically; Press the AUTO button again. After the light flashes 3 times, the light is on. At this time, the light-sensitive control mode is turned off and the normal mode is switched.

2 Charging Methods:

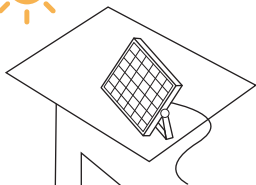

①Solar powered: install the solar panel in the direct sunlight place to charge the battery(6–8 hours, it will take longer in rainy days).

②USB charging: use 5V/1–3.6A charging devices to charge the light (3.5–4 hours).

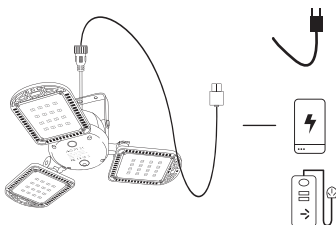

Specifications:

LED Quantity	96pcs highlight LED lamp bead
Lumens	800lm
LED Light	3.7V/7W
LED Light Material	PC+ABS
4 Brightness Level	100%\75%\50%\25%
5 Lighting Modes	1H/2H/4H/6H + Constant light
Remote Distance	8–10 meters
Waterproof Level	IP65

Manufacturer: Shenzhen Shiyu Optoelectronics Co., Ltd.

Address: 6/F, Building A, No.3000054 Yigao Industrial
Park, Xihu Road, Niuhe Community, Guanlan Avenue,
Longhua District, Shenzhen, Guangdong Province

Solar Panel	6V/3.5W
Solar Panel Material	Monocrystalline Silicon
Color Temperature	5500K
Battery Capacity	4400mAh
Battery Quantity	2pcs(2200mAh*2)
Battery Type	18650 Lithium Battery
Battery Power	3.7V/16W
Charging Time	Solar Powered: 6–8h USB Charging: 3.5–4h
Working Time	15–30h (100% brightness: 6–8h 75% brightness: 8–12h 50% brightness: 12–15h 25% brightness: 30h)
Cable Length	Connection cord: 5M/16.5ft;
USB cable	30 cm
2 Control Mode	Light Sensor/Switch Control
2 Charging Methods	Solar Powered/USB Charging
Working Temperature	–31°F~+113°F/–35°C~+45°C

Troubleshooting:

Trouble	Reason Analysis	Solution
The light doesn't work	Run out of battery	<ul style="list-style-type: none">• Connect the solar panel to the light and leave it under the sunlight to charge for at least 8 hour or use USB to charge it for 4 hours.
	In light sensor control mode, the light is in bright place	<ul style="list-style-type: none">• Cover the solar panel to turn on the light.• Press the AUTO button to switch to manual remote control mode. It can also be lit during the day.

The remote controller has no response	Remote control distance is too far	<ul style="list-style-type: none"> • Aim the remote controller at the receiver of the light, and the remote control distance is within 8–10 meters.
	The remote controller runs out of power	<ul style="list-style-type: none"> • Replace battery.
Fail to charge	Defective solar panel/battery	<ul style="list-style-type: none"> • Please contact us for help.
	The solar panel gets dirty	<ul style="list-style-type: none"> • Recommend to keep the surface of solar panel clean.
Battery life gets shorter and shorter	Solar panels don't get enough sunlight to charge	<ul style="list-style-type: none"> • Ensure that the solar panel is installed in a place that can get sufficient sunlight, and no shelter between 9:00 and 15:00 per day.

		<ul style="list-style-type: none"> • If the solar light doesn't get enough sunlight in rainy days, it can automatically return to the best working state after the weather cleared the next day and obtaining enough sunlight. • Recommend to clean the solar panel every 2 months to make charging faster and stronger. If the surface of the solar panel is not cleaned for a long time, the solar charging efficiency will be affected.
	Defective battery	<ul style="list-style-type: none"> • Please contact us for help.
The light keeps flashing	The light-sensitive system cannot tell whether it is day or night	<ul style="list-style-type: none"> • Cover the solar panel to create a dark environment. • Press AUTO to switch to manual control mode, and then switch to light-sensitive automatic mode after completely dark.

	IC problem	<ul style="list-style-type: none"> When the solar panel is not connected, the light still flashes, so there may be something wrong with the IC. Please contact us for help.
Turn on the light and only for a while at a time, then stop lighting	Battery protection	<ul style="list-style-type: none"> This is the normal battery low-power protection function of solar light, not the product quality problem, and it can be restored to normal after charging without maintenance. This is the same as the automatic shutdown of the mobile phone when it is out of power.
Unavailable after a period of time	The battery has not been charged for a long time, and it needs to be reactivated	<ul style="list-style-type: none"> Use USB to charge the light for 4 hours.